

Quick Reference Card

Understanding the User Interface Keypad

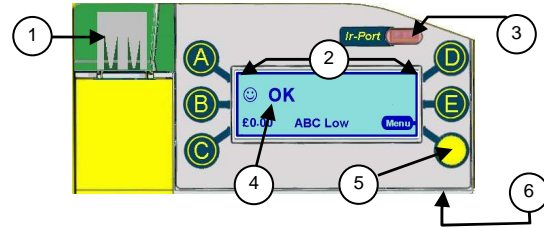

1	USB Socket	Audit, Configuration, Service
2	Buttons A to E	Dispense coins & navigate through menus
3	Ir-Port	Infra-red Audit
4	Display (LCD)	Menu information & warning display
5	Mode Button	Access service & set-up menus
6	Service Connector	Mini USB link to PC

General Keypad Button Operation

When the changegiver is in the idle state, the blue buttons can be used to dispense coins from the tubes. If however, the mode button is pressed beforehand, these buttons are used to navigate through the service & set-up menu options.

General Operation of Keypad Buttons			
A	Dispense coin from tube A	D	Dispense coin from tube D
B	Dispense coin from tube B	E	Dispense coin from tube E
C	Dispense coin from tube C	Mode Button	

The mode button can be used to access the two configuration modes available. Service Mode and Set-up mode.

Service Mode: gives access to the most frequently used product configuration options. (See Service Mode Options)

Set-up Mode: gives access to general product configuration options that are required when setting up your changegiver. (See Set-up Mode Options)

Mode Button Operation Functions	
Mode Button	Press quickly to access Service Mode menus
Mode Button	Press and Hold for 2 seconds, will access the Set-up Mode menus without a pass code required. Note: If however the changegiver had detected an error/fault, this action will take you to the test/diagnostic menu.
Mode Button + A, B, C	Access the Set-up Mode menus. You will be prompted for a pass code. Press →
Mode Button + Mode Button	Ensure tube cassette is fitted then press button twice to view changegiver audit data
Mode Button + Mode Button	Remove tube cassette then press button twice to align all dispenser arms to their home position

Service Mode Options

Press Button Sequence	Description / (Action)
Mode Button	Float coin tubes / (Insert coins then press Mode Button)
Mode Button + A + A	Clear credit accumulated – (Not MDB) & Clear Clean Me message.
Mode Button + A + D	Float teach takes a snapshot of current tube levels.
Mode Button + B	Inhibit a coin / (Insert a coin and press reject lever)
Mode Button + B	Enable a coin / (Insert a coin then press Mode Button)
Mode Button + B + A	View coin details / (press D to scroll up & E down)
Mode Button + B + B	View channel set / (press C to exit view)
Mode Button + C	Teach vend price / (Insert coins to the value of the price and then press the price line button on the machine to set it. When finished press Mode Button) This feature is only available on Executive products
Mode Button + D	Custom tube cassette teach / Enter code and press Mode Button
Mode Button + D + ? + ?	Select predefined tube cassette / (then press reject lever)

Selecting a Predefined Cassette

The changegiver has stored in memory a selection of predefined tube cassettes. Each cassette allows a different payout option to be selected. (See table below). Using the buttons on the keypad, press the button sequence as shown on the table or refer to the tube cassettes front label for the button sequence. Once the changegiver has accepted the code, the chosen cassette will be set.

To select a predefined cassette, Press Mode Button + D followed by the button code. Finally press accept to confirm.

Button Code	Tube A	Tube B	Tube C	Tube D	Tube E
AA	10p	20p	50p	20p	10p
AB	5p	5p	50p	20p	10p
AC	5p	20p	50p	20p	10p
AD	£1	20p	50p	20p	10p
AE	10p	5p	50p	20p	10p
BA	5p	20p	10p	20p	10p
BB	£1	5p	50p	20p	10p
BC	1p	5p	2p	20p	10p
BD	1p	5p	2p	20p	20p
BE	1p	5p	50p	20p	2p
CA	1p	1p	5p	20p	2p
CB	1p	5p	2p	20p	2p
CE	2p	1p	50p	£1	10p
EA	1p	5p	10p	£1	20p
EB	1p	5p	50p	£1	10p
EC					
ED					
EE					
DAA					
DAB					
DAC					
DAD					
DAE					

Accessing the Service Mode Menu

A Quick press of the yellow mode button will take you into the **Service Mode menus**. The display will change to show the options available. (see picture below). Using the blue buttons, select the option required.

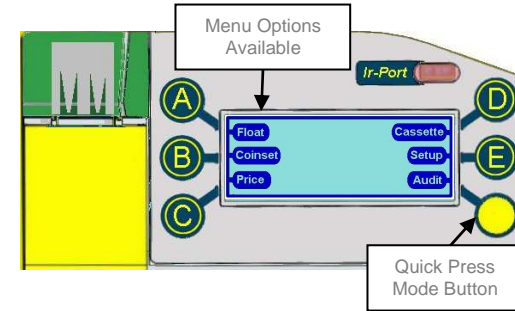

Accessing the Set-up Mode Menu

To access the **Set-up Mode** menus, press the yellow mode button followed by the E button. You will now be prompted to enter the access code. This is achieved by pressing buttons A then B then C.

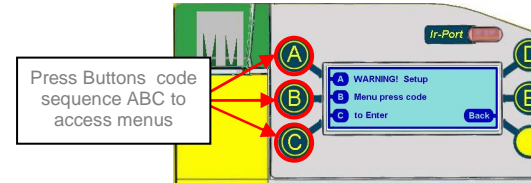

The display will now show the first available option "Prices" Press the blue D button to scroll up one level of the menu. (see picture below).

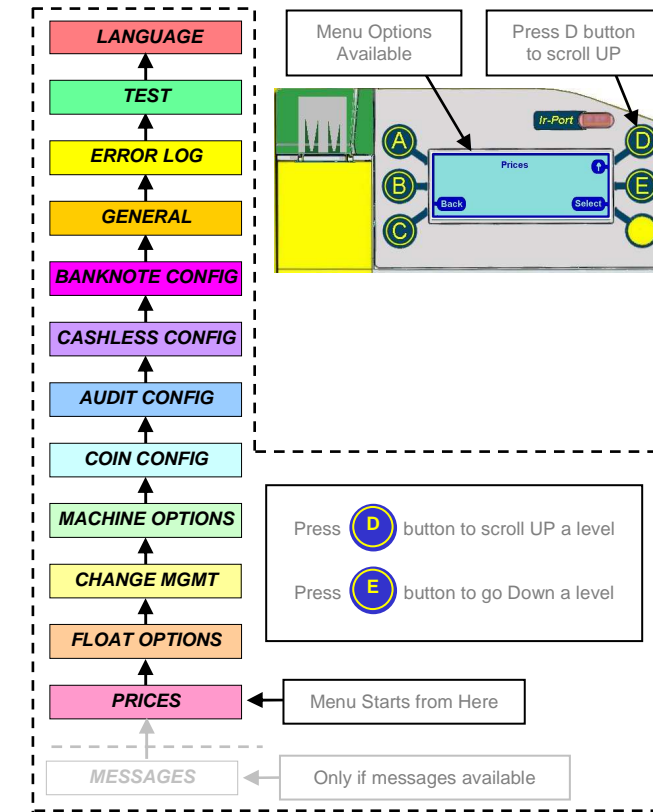

Alert Messages

An Alert message on the display allows you to pinpoint a fault that may have occurred on one of the modules of the changegiver. These types of fault can be rectified at the machine and can be for example caused by; a coin jam, dirt built up or the cassette has been removed etc.

Alert Message	Changegiver Maintenance
Alert Reject lever Menu	Discriminator error
Alert Accept gate Menu	Accept gate error
Alert Cassette out Menu	Separator module top level sensor Tube cassette error
Alert Dispenser C Menu	Dispenser module error

Display - Symbol Indicators

During the changegiver programming or normal operation, icons may be shown on the display. These icons will indicate if the changegiver requires any attention or will assist you in selecting a particular program mode.

Symbol	Meaning	Comment
Right arrow	Menu navigation	Move cursor to the right
Left arrow	Menu navigation	Move cursor to the left
Up arrow	Menu navigation	Move up through a menu or increase a value setting
Down arrow	Menu navigation	Move down through a menu or decrease a value setting
Envelope	Message waiting*	A message has been left for you to read
Smiley face		Changegiver is OK
Average face		Changegiver requires assistance
Sad face		Changegiver requires replacing
Maintenance icon	Maintenance required	Check discriminator for coin jam or dirt
Maintenance icon	Maintenance required	Check accept gate for coin jam or dirt
Maintenance icon	Maintenance required	Check separator coin level sensors for coin jam or dirt
Maintenance icon	Maintenance required	Check dispenser for coin jam or dirt

*Reading the Message: Access the setup menu in the normal way (the display will show the word "messages") and follow the instructions on the display. The envelope will be displayed until the messages have been deleted.

Set-up Mode Menus

This chart shows a detailed structure of the **Set-up** Menus. To access the **Set-up Mode** menus, Press the Yellow button followed by the E button. Enter the access code by pressing buttons **A** then **B** then **C**.

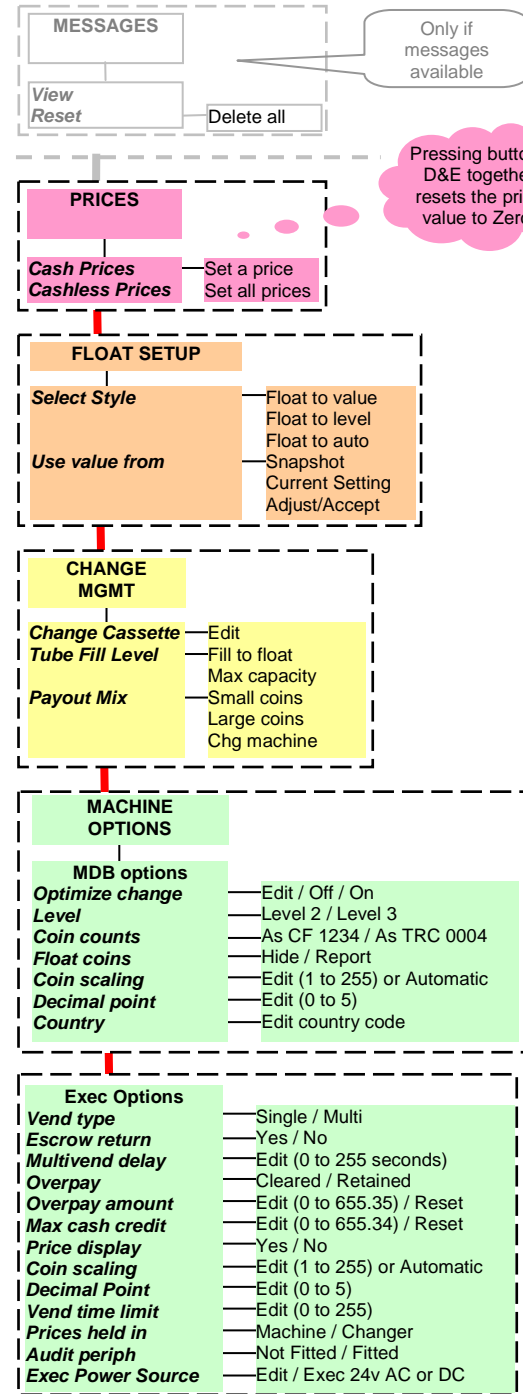

BDV Options	
Vend type	Single / Multi
Escrow return	Yes / No
Multivend delay	Edit (0 to 255 seconds)
Overpay	Cleared / Retained
Overpay amount	Edit (0 to 655.35) / Reset
Max cash credit	Edit (0 to 655.34) / Reset
Price display	Yes / No
Coin scaling	Edit (1 to 255) or Automatic
Decimal point	Edit (0 to 5)
Vend time limit	Edit (0 to 255)
Award discount	Edit (0 to 655.35) / Reset
Trigger discount	Edit (0 to 655.35) / Reset
Maximum change	Edit (0 to 655.34) / Reset
Link master id	Edit (0 to 9999)
Exact chg alg	MEI ExC / BDV ExC
BDV ExC eqn	Edit (eqn 0 to 12)
BDV ExC offset	Edit (0 to 255)
BDV ExC coin 1-14	Accept / Inhibited
Audit periph	Not Fitted / Fitted

COIN CONFIG	
Token teach	T31 / T32
Security	Hi acceptance / Hi security
Coin setup	Coin 1 to 32
Channel Setup	Channel 1 to 64
Exchange Rate	Cty1 to Cty2 / Cty2 to Cty1
Alarm timeout	Edit Alarm Time 0 -1275 seconds

AUDIT CONFIG	
Setup	Machine id Reset Reset audit Interims / Tot + Int Edit / No change / Reset
Ir POD password	Report type Basic Interims Free vends Cashless vend Report Title / Edit Install Date / Edit
Printer	

CASHLESS CONFIG	
Revalue	Yes / No

BANKNOTE CONFIG	
Highest value	Edit (0 to 655.34) / Reset

GENERAL	
Calibrate tubes	Calibrate
Accept Coins	Cty1/Mixed/Cty2
Cleanme level	0 to 64 (32 = 50%)
Default Menu	Advanced / Basic
Keypad	Basic
	Enabled/Inhibited
	Coinset
	Enabled/Inhibited
	Prices
	Enabled/Inhibited
	Cassette
	Enabled/Inhibited
	Setup
	Enabled/Inhibited
Settings	Save / Restore

ERROR LOG	
View	Last 10 errors
Reset	Reset error log? Accept / Cancel

TEST	
Module	Coin sensors Accept gate Gate sensor Separator Cassette Dispenser Temperature Comms
Connectivity Information	Audit MDB periph VMC Other
	Testing % done
	Coin Changer
	View information
	Cashless
	View information
	Banknote Reader
	View information

LANGUAGE	
Language	Not set English US Française CN Español US English UK Deutsch Française EU Nederlands Español EU Portugués Italiano Polski Russian Hrvatski

USB Audit Mode

Auditing the CF8000 using an 'Audit' defined USB stick *

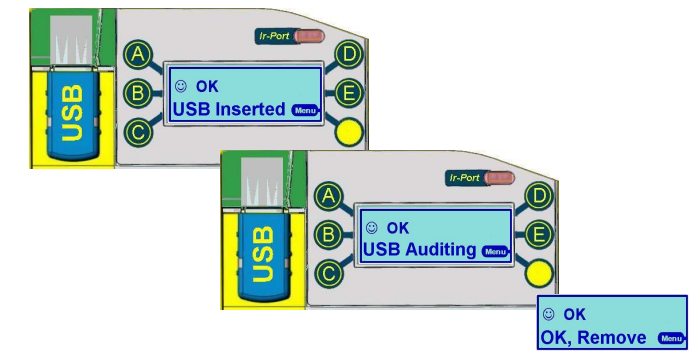

USB Configuration/Application Mode

Updating the CF8000 using a 'Configuration/Application' defined USB stick *

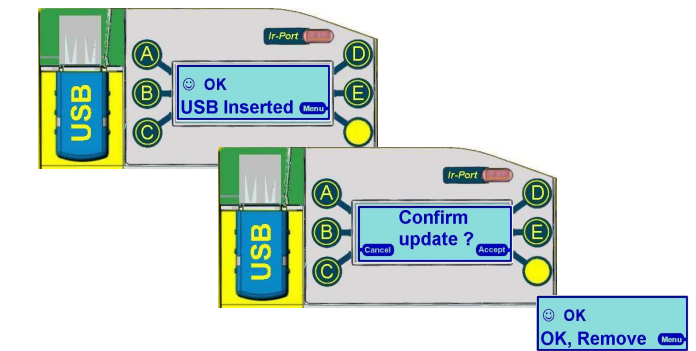

USB Service Mode

Additional configuration options available to a service engineer. This menu is not available unless you have a 'Service' defined USB stick.*

Program clone	
Acquire clone	Acquire w/audit Back / Select Acquire wo/audit Back / Select
Update menu	Upd config Back / Select Upd firmware Back / Select Update all Back / Select
Time and date	Time Back/ Select/ Edit Date Back/ Select/ Edit
Retrieve logs	Select Retrieving data
Audit menu	Audit wo/reset Auditing Audit with reset Auditing
Setup menu	Prices....

* STS V7.00 required to define USB stick properties.